

car
ing
sh
ar
ing
pr
e
p
ar
ing



Paraparaumu Beach School

Newsletter 2018/20

26 June 2018

Upcoming Events

WEEK 9

Tues, 26 June

- Yr 8 College Orientation at Kapiti College

Wed, 27 June

- Teachers' Paid Union Meeting—**SCHOOL CLOSED FOR INSTRUCTION from 12.30pm**

Fri, 29 June

- Marcel Bernard (speaker) Yrs 5-8

WEEK 10

Tues, 3 July

- Regional Cross Country

Wed, 4 July

- School Assembly 9.20am—all Welcome! (weather permitting)

- Tu Meke time

Fri, 6 July

- Mid-Year Reports come home/LAST DAY T2

TERM 3

WEEK 1

Mon, 23 July

- First day of Term 3

Tues, 24 July

- Board Meeting—7pm

PRINCIPAL'S MESSAGE

Hi Everyone

Brrrrrr....we've had some frosty mornings recently! So frosty in fact that kids have been able to pick up long shards of ice. The ice is hard to see in this photo, but it was lovely to see how the simple delights of nature provide excitement and fascination for kids.

This week our new Accounts Manager, Libby Richardson, has joined our office team. We had a really strong pool of applicants for this position, so we were spoiled for choice. Ultimately, Libby edged out the other applicants and we are delighted to welcome her on board. Libby will work alongside Eva for the next two weeks, before Eva departs.

Warm regards

Jess Ward - Principal/Tumuaki

PS: Did you know that out of 670 students, 561 are registered for our KINDO payments system! That's nearly 84%. We hope you are finding KINDO and easy way to pay



Welcome to our New Students

Ryan and Lani, both Rm 20.

WELCOME

**Embrace our Education
Enhance our Future**

TEACHER'S FINAL PAID UNION MEETING FOR 2018— TOMORROW (WEDNESDAY)

Please remember that **tomorrow** teachers will be leaving school at 12.30pm to attend a paid Union Meeting in Porirua. I will remain at school with teacher aides and office staff, and whilst we are happy to supervise students unable to be collected, we would appreciate parents making alternative arrangements for collecting students early on this day.

**Don't
Forget!**



The task of teaching is increasingly more complex than it was 20+ years ago; these negotiations are about so much more than the pay. Teachers need better conditions, more support for students with learning and behaviour needs, and smaller class sizes. NZ is already facing a teaching crisis – fewer people are training to be teachers. We need to make teaching a more enticing, viable and sustainable career so we can overcome the current shortage.

We sincerely hope these collective contract negotiations can address some of these aspects for all NZ teachers, as we do not want this to lead to teacher strike.

Thank you for your understanding and support.

Jess Ward

BOARD OF TRUSTEES

BOARD OF TRUSTEES NEWS

On behalf of the Board of Trustees, thank you to the school community for your support for the first half of 2018.

The remodelling is going well, and the board appreciates the co-operation and support of the staff, students and community in keeping the year running well while this is underway. The playground remodelling has also progressed well, and we are looking forward to having modern, safe and engaging classroom and playground spaces for the future.

The winter sports season is well under way, and it is great to hear of the achievements of our athletes in the various competitions around the region. Especially pleasing is the feedback from organisers and attendees that our school representatives and supporters are embodying the school's values and behaving in a supportive and respectful manner. The Board would just like to remind the parent community that the school's CREST values (Co-operation, Respect, Excellence, Self Management and Tolerance) are attributes that we would appreciate being modelled by the parents towards each other, the students and the school staff. It makes our interactions more pleasant, productive and effective, and demonstrates to our students appropriate ways to behave.

The parent survey results have been distributed. The board had already been progressing some of the ideas put forward and have taken some of the others on board for consideration for future plans.

Julian Morrin
Board Chair

WERE YOUR EARS BURNING? Staff Gratitude Section

Recently I've been aware of the many extra hours Sandy Saunders has been putting in to make PTA fundraisers a success. Most days before and after school, Sandy can be found in the office sorting Entertainment Books and recyclable bags for sale. Over the weekend she spent most of her time filling orders and cross-checking lists for the recyclable bags.

Whilst I wish she'd had help, I know that once Sandy sets her mind to a task she gets stuck in boots n' all! Thank you Sandy – you have really exceeded yourself. The money being raised will benefit our PBS kids so much.



KIDS QUOTE



Some five year olds brought a notice to the office recently. They came in holding hands, looking a bit overwhelmed with the responsibility they'd been given. They handed the notice into Paula and then headed back out the door. As the door closed we heard one of them say:

“See that wasn’t scary!”

RE-USABLE BAGS

Wow! What a great week!

We have had a fantastic response so far with our reusable bag launch. Thank you to all those families that have returned their money and bags. Don't forget to keep selling the bags as this is a great way to help raise money for our school and at the same time look after our environment.

If you need any more bags, please either see Paula in the office or Whaea Sandy in Rm 22.



NEW ENTRANT PARENT INFORMATION PRESENTATION—TATAHI SYNDICATE

A New Entrant Information Presentation will be held for all parents of new entrant children this Friday, 29 June from 9.30-10.15am in the staffroom. This session will:

- ◇ Provide an overview of the “transition to school”
- ◇ Provide an overview of the New Entrant Programme in reading, writing and mathematics
- ◇ Highlight how you can help at home with learning

In Tatahi Syndicate, we believe that successful partnerships between home and school are established when both parties have a shared expectation and knowledge of their child's learning. We would love to see you there.

STUDENT WORK

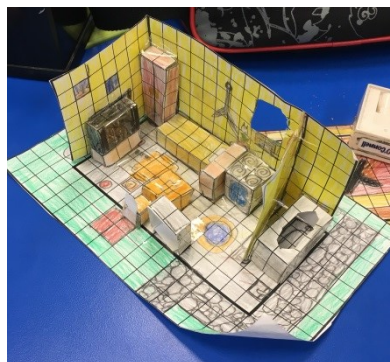

As part of a maths challenge, Room 8 students have been planning and creating tiny houses. The rules have been strict, with requirements for space allowance between items of furniture and alike. The creations I've seen so far are magnificent.



There is lots of wonderful Matariki artwork around the school at the moment, but these creations in Room 22 really caught my eye. The clever blend of collage, painting and photos has resulted in a lovely final product. Great work!

OLD TOYS AND APPLIANCES WANTED

Do you have any old, unwanted or broken toys, appliances or electronic items that would be suitable for taking apart? Rm 29 would appreciate them! Small items can be dropped off to Rm 29. Please email Mr Parr on dparr@pbs.school.nz if you have larger items.



Many thanks :-)

GLASSES FOUND

A pair of prescription glass was found on the deck outside Rooms 28/29 on Monday morning. If these are yours, please see the office.



LOST PROPERTY

Lost property will be on display during the last week of term out by the netball courts facing the quad side on fine days. And as it may be a bit wet during the last week, keep an eye out during the fine days of this week. Anything un-named will be sent to the Koha Shed.

Do you know where the lost property is normally kept? You can check out the lost property now housed at the back of the old dental clinic area behind the doors as shown below:

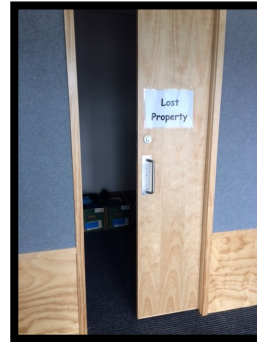

TE MOTU TIKI TOUR THANKS

Last Tuesday 167 Te Motu students went on a local history Tiki Tour around many of our local heritage sites. We had a fantastic day and learnt heaps along the way.

We would like to send a huge thank you to all of the parents and grandparents who gave up their day to transport us around the district. We appreciated your help so much.

A very special mention must go to:

- ◇ Grant and Nadine Williams who provided two cars, yet only had one child who was theirs!
- ◇ Hamish Garratt who's child was sick and could not come on the trip, but Hamish still came
- ◇ Sharleen MacInnes who drove her 10 seater and provided a 7 seater for another driver, meaning we were able to take everyone from the syndicate.

Thank you all so much for helping make this a great success!



ENTERTAINMENT BOOK RETURN—URGENT REMINDER

Please remember to return your unsold Entertainment Books/ payments to the school office. These are now overdue. Thank you.



JUICEES & COOKIES

Juicees and cookies are for sale on Friday lunchtimes outside Rm 17—\$1 each.



GIRLS RIPPER RUGBY TOURNAMENT

A huge thank you to Sharleen MacInnes, Theresa Barr and Lynz Batty for coaching our three teams last Thursday. Well done girls for playing nine games with limited subs!! Thanks for representing our school so well:



Alexis MacInnes, Lucy Marshall, Samantha Millar, Stacey Collett, Shinae Bett, Emma Jane Coggan, Ella Finlay, Oli Sinclair, Phoebe Bayley, Marama Peipi-Stanley, Mikayla Mandich, Maggie Graham, Taryn Holloway, Korey Kavakura, Tristina Kirkwood-Cudby, Maddie McDowell, Angela So, Tara Snowsill, Jamie Tidy, Grace Garratt, Maggie Webb, Nyah Tonga, Lisa Byrne, Samara Cooper, Anika Barr and Hannah Batty-Tofts.



Understanding ‘Mid Year’ Reports

With National Standards now removed, we have returned to reporting progress and achievement against the New Zealand Curriculum Levels. We feel this system is more useful and appropriate at the Primary School Level.

The New Zealand Curriculum has 8 “curriculum levels” (see diagram below) which stretch from Year 1 to Year 13. Each level represents a learning stage in each curriculum area. Most students will progress through levels 1-4 while at Paraparaumu Beach School. The curriculum level that each student is learning at may vary compared to the other students in the same year. Once your child has mastered most of the skills, knowledge and understanding within a curriculum level, the next level will be incorporated into their learning.

The chart below shows how the curriculum levels typically relate to years at school. Not all students however, fit this pattern. Students with special learning needs, those who are gifted, and those who come from non-English speaking backgrounds are examples of these exceptions. It is important to remember that curriculum levels are of more importance to us than to your child, because we use them to guide our teaching, assessment and evaluations of learning.

Your child’s progress against the New Zealand Curriculum levels will be indicated on your child’s report at mid and end of year. Teachers will use of a range of assessment tools to make overall judgements. These will show where your child sits in relation to the curriculum level appropriate for their year group.

If you are in any way concerned or surprised about your child’s progress, then please raise this with their classroom teacher.

Curriculum Levels

This chart shows how the curriculum levels fit within each Year group

